



Touchless - NO Touch Exit Buttons

SS-304 PLATE

Dimensions : American Size
ANSI Standard



Led Color Change on
Waving of Hand



Fast Response & Higher Detection Range

Detection range Adjustable from 4 cm to 15mm

Multi-Voltage Input : 12-24 vdc

Models :

Sek-600-NT- Momentary Signal)

Sek-600-NT-Timer (Adjustable Timer)

Sek-600-NT - TD- Timer & Distance
(Adjustable Timer and Distance)

Specification

- Size: 114 mm by 70 mm
- Standard Structure: Steel Button
- Current Rating: 3A@36VDC Max
- Output Contact: NO/NC/COM
- Mechanical Life: 500000 tested
- Suitable for Door: Hollow Door
- Operating temp: 10~+55°C(14-131F)
- Operating Humidity: 0-95%(relative humidity)
- Weight: 0.23kg
- Actual Product might look Slightly different from Photos shown above

Wiring Diagram

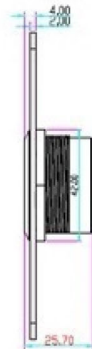
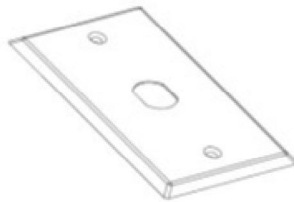
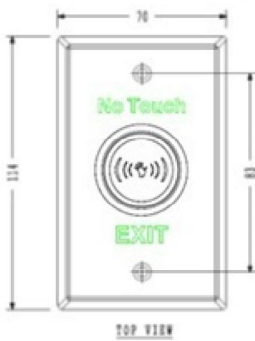

Led Detection Behaviour

- LED Indicator:
 - White LED indicator: Power OFF
 - Red LED indicator: Power ON(standby)
 - Green LED indicator: Power ON(sensation)

Installation

